

WALWORTH COUNTY
SURVEYING & MAPPING
LAKE GENEVA, WISCONSIN

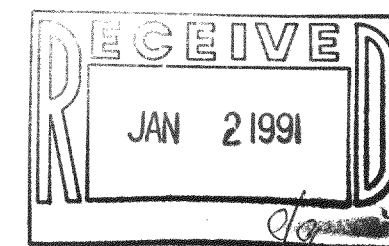

PLAT OF SURVEY OF

PARCEL A: LOT 93, BUBBLING SPRINGS SUBDIVISION, SECOND ADDITION, ON THE TOWN OF LAGRANGE, ACCORDING TO THE PLAT THEREOF RECORDED VOLUME 14 OF PLATS, PAGES 11 TO 14, INCLUSIVE, WALWORTH COUNTY, RECORDS.

PARCEL B: THE AREA DESIGNATED "MARSH" AND SHOWN ON IT 2 OF THE PLAT ENTITLED "SECOND ADDITION TO BUBBLING SPRINGS SUBDIVISION" RECORDED MAY 15, 1961 IN VOLUME 14 OF WALWORTH COUNTY PLATS, PAGE 14, INCLUSIVE, DOCUMENT NO. 528985, SAID MARSH AREA BEING BOUNDED ON SOUTH BY THE SOUTH LINE OF SAID PLAT AND BEING BOUNDED ON THE WEST AND EAST BY (READING CLOCKWISE) LOTS 82 TO 94 INCLUSIVE, IN SAID T.

ORDERED BY: COLDWELL BANKER
GENEVA LAKES AREA REALTORS
838 MAIN STREET
LAKE GENEVA, WISCONSIN
53147

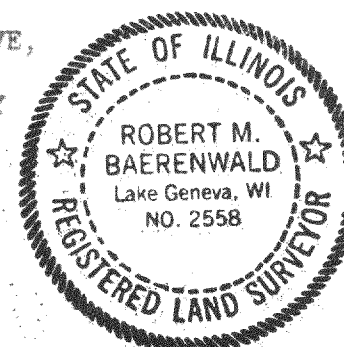

I HEREBY CERTIFY THAT I HAVE SURVEYED THE ABOVE DESCRIBED PROPERTY AND THAT THE ABOVE MAP IS A TRUE REPRESENTATION THEREOF AND SHOWS THE SIZE AND LOCATION OF THE PROPERTY, ITS EXTERIOR BOUNDARIES, THE LOCATION OF ALL VISIBLE STRUCTURES AND DIMENSIONS OF ALL PRINCIPAL BUILDINGS THEREON, BOUNDARY FENCES, APPARENT EASEMENTS, ROADWAYS AND VISIBLE ENCROACHMENTS, IF ANY.

THIS SURVEY IS MADE FOR THE USE OF THE PRESENT OWNERS OF THE PROPERTY AND ALSO THOSE WHO PURCHASE, MORTGAGE OR GUARANTEE THE TITLE THERETO WITHIN ONE (1) YEAR FROM DATE HEREOF.

Robert M. Baerenwald
ROBERT M. BAERENWALD
WISCONSIN REGISTERED LAND SURVEYOR, S-1508

DATE *Sept. 8, 1989* JOB NO. 2048

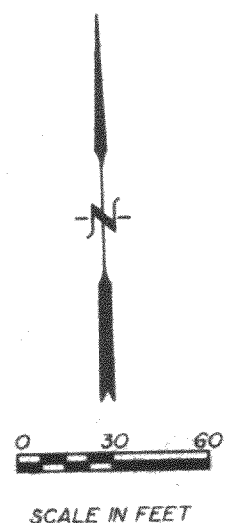

LEGEND

⊕ - IRON PIPE FOUND.

ABS2 00075